

TYPE HH

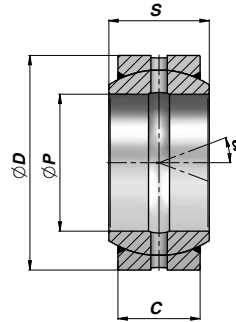

TYPE HH...2RS

Code Type HH	Code Type HH...2RS	ØP	ØD	S	C	α	FC (kN)	kg
*HH0120000	-	12	22	10	7	11	10,8	0,01
HH0150000	HHE0001425	15	26	12	9	8	17	0,02
HH0160000 (A)	-	16	30	14	10	10	21,2	0,03
HH0170000	HH0001426	17	30	14	10	10	21,2	0,04
HH0200000	HH0001427	20	35	16	12	9	30	0,06
HH0250000	HH0001428	25	42	20	16	7	48	0,11
HH0300000	HH0001429	30	47	22	18	6	62	0,14
HH0350000	HH0001430	35	55	25	20	6	80	0,22
HH0400000	HH0001431	40	62	28	22	7	100	0,30
HH0450000	HH0001432	45	68	32	25	7	127	0,40
HH0500000	HH0001433	50	75	35	28	6	156	0,54
HH0600000	HH0001434	60	90	44	36	6	245	1,00
HH0700000	HH0001435	70	105	49	40	6	315	1,50
HH0800000	HH0001436	80	120	55	45	6	400	2,20
HH0900000	HH0001437	90	130	60	50	5	490	2,70
HH1000000	HH0001438	100	150	70	55	7	610	4,30
HH1100000	HH0001439	110	160	70	55	6	655	4,70
HH1200000	HH0001440	120	180	85	70	6	950	8,00

FC = MAX DYNAMIC LOAD

* WITHOUT GREASE NIPPLE

(A) = WITHOUT STANDARD

COUPLING - STEEL/STEEL

MATERIAL:

STEEL - ISO 1240-1 SERIE E